

# SPINDLES

Tough 5/16" Steel for Long, Dependable Service.

## STRAIGHT SPINDLES



1632 — 4" (furnished to order 4½" or 5")



1832 — 5"

## SWIVEL SPINDLE



1631 — 4"  
(furnished to order 4½" or 5")

## CLOSET KNOB SPINDLES

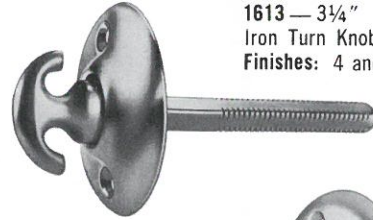

1613 — 3¼"  
Iron Turn Knob; Rose 155  
Finishes: 4 and 10

22F — 3¼"  
Brass and Bronze  
Rose 155

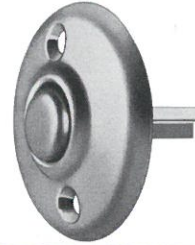

Finishes: 3, 4, 10, 26, 26D

## HALF SPINDLES

For sets operated by knob from one side only.



1630 — 2¾"

# ACCESSORIES



## KEY PLATES

618: Cold Forged Brass and Bronze  
Finishes: 3, 4, 10, 26, 26D  
Fits Key 979



618MA: Extruded Brass, Bronze, Aluminum  
Finishes: 3, 4, 10, 26, 26D, 28  
Fits Key 979

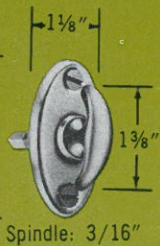

## TURN KNOBS

125: Brass, Bronze and aluminum  
Wrought Plate, Forged knob  
Finishes: 3, 4, 10, 26, 26D, 28  
Regularly furnished with 3/16" Spindle.

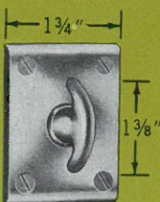

125MA: Brass, Bronze, Aluminum  
Extruded plate, Forged knob  
Finishes: 3, 4, 10, 26, 26D, 28  
Regularly furnished with 3/16" Spindle.

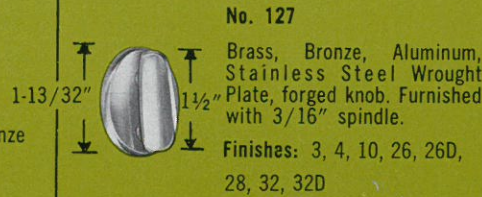

No. 127

Brass, Bronze, Aluminum, Stainless Steel Wrought Plate, forged knob. Furnished with 3/16" spindle.

Finishes: 3, 4, 10, 26, 26D, 28, 32, 32D

## HOTEL LOCK INDICATOR (9)

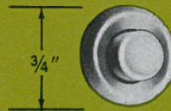

Cast Brass and Bronze  
Finishes: 3, 4, 10, 26, 26D

Furnished to order on escutcheons with Hotel Locks 6750, 7750, and 7752.

Button cannot be pushed in when door is locked from inside. This indicates to hotel maid that room is occupied.

## CYLINDER ROSETTES



1: Cast Brass and Bronze  
Finishes: 3, 4, 10, 26, 26D

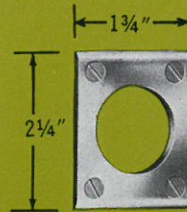

1MA: Extruded Brass, Bronze, Aluminum  
Finishes: 3, 4, 10, 26, 26D, 28

## DROP HANDLE 76F

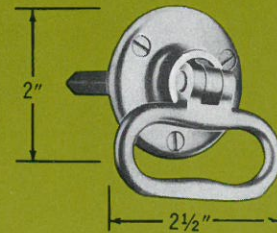

Cast Brass and Bronze  
Finishes: 3, 4, 10, 26, 26D

Furnished with 5/16" straight threaded spindle. Any Sargent knob suitable for threaded spindles may be used with this Drop Handle.